



cuadc.org  
Cambridge University  
**Amateur  
Dramatic  
Club**

# OFFSTAGE

THE ADC NEWSLETTER:

EASTER 2008

EDINBURGH SPECIAL

www.cuadc.org

offstage@cuadc.org

## EDITORIAL

It has been a successful term of theatre in Cambridge with 8 shows, and well done to everyone involved. With the ADC closed until Michaelmas term 2008, our attention turns to elsewhere venues. We have several shows lined up for this term: see our

website for more details on how to get involved. If you've recently joined the ADC, I hope you enjoy reading a bit about what's been going on in this, our termly newsletter. We're always on the lookout for Offstage articles, so if you fancy being in print, get in touch at [offstage@cuadc.org](mailto:offstage@cuadc.org). Remember to check our website for show details and other info.

*David Pugh*

## ADC THEATRE REDEVELOPMENT

With the ADC theatre now closed for the final stage of the redevelopment here's what you can look forward to. There will be an exciting new soundproof rehearsal room, disabled access to the stage, a new rake with new comfy seats, beautiful new dressing rooms, and for the Techies: a decent workshop with several new tools and a gigantic prompt side wing where massive sets can live.

*David Mack*

### THE NEW ADC COMMITTEE

On the 2<sup>nd</sup> of March, the ADC committee held its AGM, at which voting was open for the committee of 2008-2009.

President: Tim Checkley

([president@cuadc.org](mailto:president@cuadc.org))

Secretary: Jonathan Spriggs

([secretary@cuadc.org](mailto:secretary@cuadc.org))

Junior Treasurer: Emily Taylor

([jt@cuadc.org](mailto:jt@cuadc.org))

Technical Director: David Mack

([td@cuadc.org](mailto:td@cuadc.org))

Director's Rep: Anna Marsland

([director@cuadc.org](mailto:director@cuadc.org))

Producer / SM Rep: Joe Shaw

([producer-sm@cuadc.org](mailto:producer-sm@cuadc.org))

Technician: Stuart Moore

([technician@cuadc.org](mailto:technician@cuadc.org))

Publicist: Adam Wood

([publicist@cuadc.org](mailto:publicist@cuadc.org))

Communications Officer: David

Pugh ([comms@cuadc.org](mailto:comms@cuadc.org))

Designer: Georgia Artus

([designer@cuadc.org](mailto:designer@cuadc.org))

Actors' Reps: Lowri Amies

& Josh Higgott ([actors@cuadc.org](mailto:actors@cuadc.org))

General Members: Kat Upton

([kat.upton@cuadc.org](mailto:kat.upton@cuadc.org)), Oscar Toeman

([oscar.toeman@cuadc.org](mailto:oscar.toeman@cuadc.org))

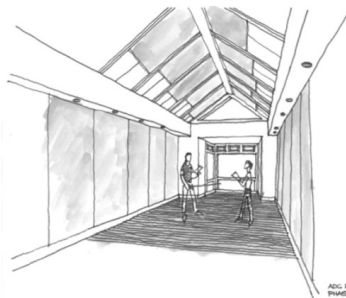

ADC REHEARSAL ROOM PHASE 2B

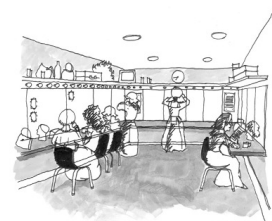

NEW DRESSING ROOM PHASE 2B

THE ADC THEATRE



PHASE TWO B

NEW DRESSING ROOMS, REHEARSAL ROOM EXPANDED WORKSHOPS AND WING SPACE

Artists Impressions of, clockwise: the new rehearsal room, the refurbished dressing rooms, the ADC theatre. ©Barry Brown for Bland, Brown and Cole Architects

## LOOKING TOWARDS EDINBURGH

We have two shows heading to Edinburgh this year, the *Real Inspector Hound* by Tom Stoppard, directed by Ed Kiely, and *HERO*, a musical written by current Cambridge students Ashley Riches and Ben Nicholls, and directed by Matt Eberhardt.

### Edinburgh Previews

#### The Real Inspector Hound (C+2):

Higgs, the premiere theatre critic, has disappeared, so Moon fills in. On stage, Inspector Hound seeks a murderous madman. But who is the body behind the chaise longue? In Tom Stoppard's theatrical whodunit, where does theatre end and reality begin?

Set in a theatre during a production of an Agatha-Christie-esque murder mystery, *The Real Inspector Hound* cuts between the action on stage and the reactions of two critics watching the play. Progressively the distinction between theatre and reality becomes blurred with hilarious and tragic consequences for the characters. Especially the critics.

Stoppard takes great pleasure in toying with the audience's expectations, both in the plotline of the play itself and within the wider realm of the theatre. The difficulty presented by the *Real Inspector Hound*, and what makes it so exciting and challenging to take to Edinburgh, lies in making the production reflect the theatrical climate of the festival. How far can criticism be objective? How dependent is theatre on a number of tired conventions? And, more philosophically, where does drama end and reality begin?

*Kat Upton*

#### HERO (C-1):

*HERO* tells the story of Telephos as he flies, falls and finds, following him around Ancient Greece, quite literally to Hell and back, as he tries to discover the meaning of being a real hero. Fast-paced and action-packed, crammed with loveable characters and memorable songs, *HERO* is a show which will have you laughing, crying and desperately trying not to stand up and join in! From Cambridge University, birthplace of the genius of Fry, Laurie, Cleese and Baron Cohen, comes a new musical.

*HERO* is an eclectic and exciting take on the conventional musical theatre love story, fully aware (musically and textually) of its place in a long line of musical theatre genres and styles, yet it is fully its own, not derivative or imitative in any way. Written by two ADC members, Ashley Riches and Ben Nicholls we are proud to be taking this piece of new writing to the Edinburgh Fringe. It's hard to know what to say about new writing before it's been tested in front of an audience, but we think the best thing so far is the reaction we've had when extracts from the score have been played to friends, family and complete randomers. The lyrics are "beautiful" and "haunting", the music "incredibly powerful".

Of course new writing is difficult to sell; we all know that. But where better to try and test a new musical than the Edinburgh Fringe, with its generously critical and open audiences? With its racy plot, huge range of songs and lovable characters *HERO* promises an incredible hour or two of musical theatre, and we're confident that with a good publicity and production team we can sell the show far and wide. If you're in Edinburgh this August (or in Cambridge through July) come and check us out at C-1!

*Hero Company*

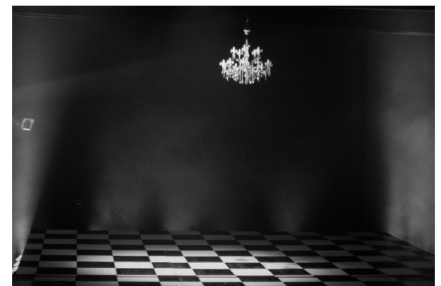

Photos (from top to bottom): Tim Johannson, Sarah Latto, Kat Upton and Joe Shaw; the White Devil set; Alex Guelff; Ed Stephenson, Charlotte Langley, Mel Heslop and Ned Stuart-Smith ©John Linford 2008

## WHAT'S ON

This Term the ADC has three shows on:

**Journey's End** by R.C.Sherriff: 7pm, 6th - May @ Corpus Christi Playroom,

**Yellow Moon** by David Greig: 8.30pm, 7th - 10th May @ The School of Pythagoras, St John's College,

**High Society** by Cole Porter & Arthur Kopit, ADC May Week Musical: 12am, 17th - 19th Jun @ Emmanuel College Gardens  
Offstage Newsletter Easter Term 2007, edited by David Pugh & the CUADC Committee. All articles © their respective authors. Please direct comments to [offstage@cuadc.org](mailto:offstage@cuadc.org)